

Manual

Angle grinder stand

For
4 1/2"
angle grinders

Applies for:

Code	Model
102273	SOP-E45

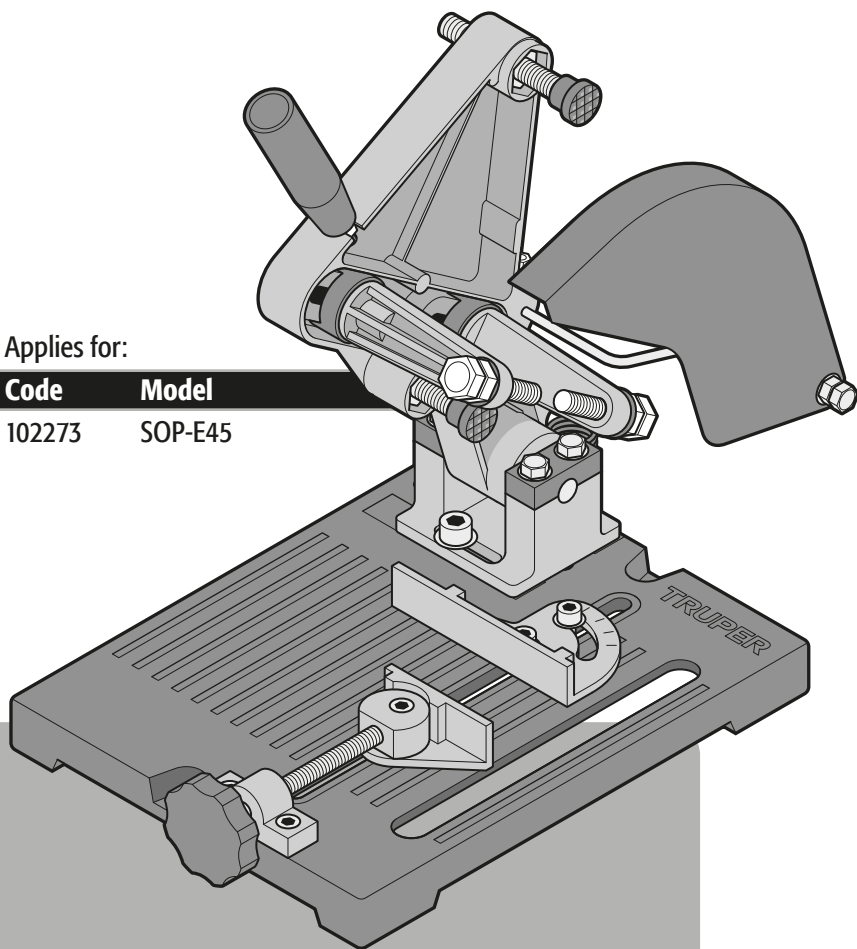



CAUTION



Read this manual thoroughly
before using the tool.



Technical data	3
 General safety warnings for the use of grinding machines accessories	3
 Safety warnings for the use of angle grinder stand	4
Parts list	5
Assembly	5
Parts	7
Setup	8
Start Up	9
Warranty policy	10

CAUTION

To gain the best performance of the tool, prolong the duty life, make the Warranty valid if necessary, and to avoid hazards of fatal injuries please read and understand this Manual before using the tool.

Keep this manual for future references.

The illustrations in this manual are for reference only. They might be different from the real tool.

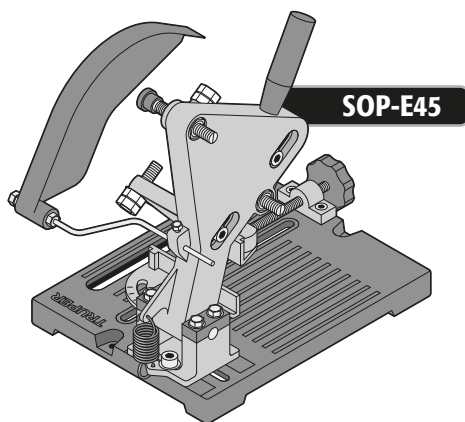

SOP-E45

Code •	102273
Description •	Angle grinder stand
For grinders of •	4 1/2"
Maximum cutting depth •	to 45°: 3/4" x 3/4" to 90°: 3/4" x 1 3/4" The cutting depth may decrease depending on the design of the grinder.
Maximum press opening •	3 3/4"
Angle cuts •	0° - 45° left

General safety warnings for the use of grinding machines accessories

Keep your work area clean, tidy and well illuminated.

CAUTION Untidy and dark areas cause accidents.



Keep children and others at a safe distance while operating the tool.

WARNING Distractions can cause you to lose control and lead to accidents.



Always be alert, use caution and common sense.

CAUTION Do not let familiarity with the tool distract you while operating it.

Do not use the tool if you are tired, or under the influence of drugs, alcohol or medication.

DANGER A moment of inattention while operating the tool may result in serious personal injury.

Use the tool with all parts in place and in good condition.

WARNING Failure to do so may result in serious personal injury.

Properly secure and support the workpiece.

CAUTION Use clamps and a stable work surface.

Never force the tool.

CAUTION Working within the range for which it was designed ensures better and safer working.



Store the tool in a safe place out of the reach of children.

WARNING Tools are dangerous in inexperienced hands.



Wear the right clothes.

WARNING Loose clothing or long hair can be caught in the mobile parts.



Keep hands away from rotating and/or moving parts.

WARNING Failure to do so may result in serious personal injury such as cuts, burns or crushing.



Use appropriate personal protective equipment.

CAUTION Wear eye protection. Dust mask, non-skid shoes, hard hat and hearing protection.



Do not overreach.

CAUTION Good footing and balance allow better control of the tool in unexpected situations.

Properly secure the accessory to the tool.

CAUTION Do not use accessories without first making sure they are properly attached and secured. Otherwise, they may be thrown at the operator.

Remove any adjusting key before operating the tool.

WARNING Additional tools or wrenches placed on a rotating part of the tool may cause serious personal injury.

Maintain the tool and make sure that it is in proper condition before using it.

CAUTION Carefully check its moving parts, alignment and mounting. Do this periodically. Look for any damaged or malfunctioning parts for immediate repair at a **TRUPER** Authorized Service Center.



Accessories.

CAUTION Use only the accessories or spare parts indicated in these instructions or certified by **TRUPER**.

General

- The grinding machine mounted on the stand is suitable for cutting metals.
- Do not use worn or damaged discs.
- NEVER use discs that are larger than the size indicated for the tool.
- Wear gloves when handling the discs.



Before operating the tool

- ⚠ CAUTION** • Hold the workpiece properly to avoid body contact with the cut-off wheel, bending of the cut-off wheel or loss of control of the tool or workpiece.
- ⚠ CAUTION** • Before each use, check that the guard is properly positioned. It is always recommended to use the machine guard.
- Make sure that the blade is properly installed, make sure that it has no bumps or damage. If so, replace it immediately.
- Use the support in such a way that no person is in the cutting line of the blade.
- Keep the grinder stand on a perfectly level surface, where there is enough space to properly handle and support the workpiece.
- Be sure to tighten all screws and clamps before turning on the grinder.

While operating the tool

- ⚠ WARNING** • Put hands or any part of your body away from the cutting area and cutting disc. When operating the tool firmly hold the cutter head by its handle to prevent accidental injuries and to prevent losing control.
- ⚠ DANGER** • Accidental contact with a rotating cutting disc could cause severe personal injury.
- ⚠ CAUTION** • Never cut hands-free nor with a loose work piece. The clamping screw should fasten it.
- Keep your body on a side of the cutting axle away from sparks or residues thrown by the tool.
- ⚠ CAUTION** • Do not try to remove scrap material while the cutting disc is rotating.

⚠ WARNING • Remember that the guards do not protect you from the moving disc under the workpiece, so never reach under the workpiece while the tool is running.

⚠ WARNING • ALWAYS keep the power cord away from the cutting area. The power cord should NEVER hang over the workpiece when cutting.

⚠ CAUTION • Never remove the debris accumulated on the disc by hand, use a brush to remove the debris.

⚠ CAUTION • Do not attempt to free a jammed disc without first switching off and disconnecting the tool.

⚠ CAUTION • Do not try to stop the disc with a piece of wood or with the spindle lock. Allow it to stop freely after turning off the grinder.

⚠ CAUTION • Hold it by the insulated parts. If you accidentally cut a power cord, the metal parts will shock the operator. In this case, switch off and disconnect the grinder immediately.

• For parts that protrude from the base, support them on the left side and use auxiliary supports if required.

After operating the tool

- Make sure the disc comes to a complete stop before replacing it, secure a work piece, change de cutting angle or turn off the tool.
- Check from time to time all the nuts and screws are duly tightened.

Parts list



1. Mobile body with a set of screws and washers.
2. Set of screws, bushing and nut for 3 grinder hole sizes:
M6 (x2)
M8 (x2)
M10 (x2) (Bushing not included)
3. Swivel arms with bushing and bolts (x2)
4. Spark deflector
5. Leveling screws (x2)
6. Lever
7. Adjustable press iron base.
8. 0.19" hex wrench
9. 0.23" hex wrench

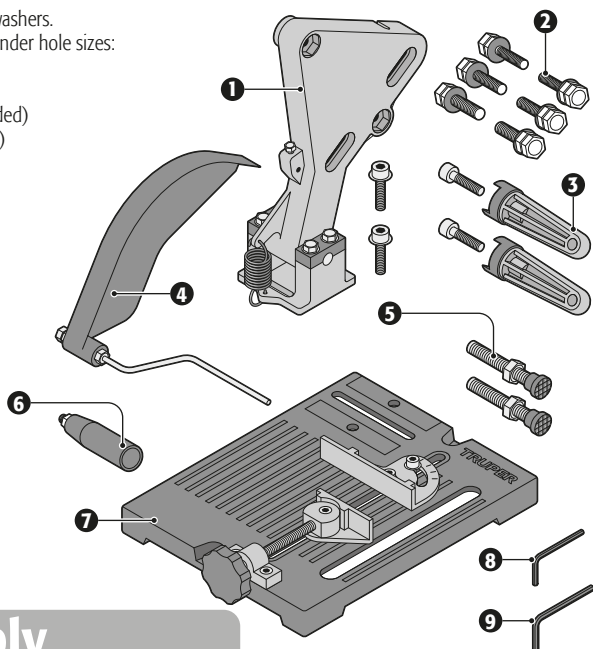

Assembly

- Attach the mobile body (A) to the base (B) with the two 5 mm hex head washer screws (C) and tighten with the included wrench (8).
- Fix both leveling screws (D) in each of the holes of the mobile body (The longer leveler at the top and the shorter leveler at the bottom).
- Fix the rocker arms with bushing (E) to the moving body with the two 0.23" (6 mm) hex head bolts (F), tighten with the included wrench (9).
- Fix the lever (G) on the mobile body with the supplied washer and nut.

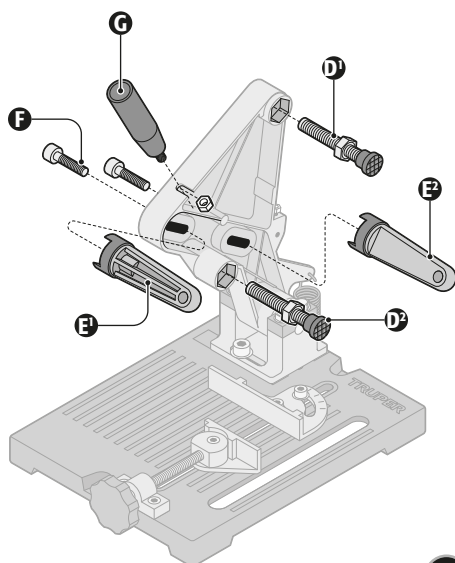
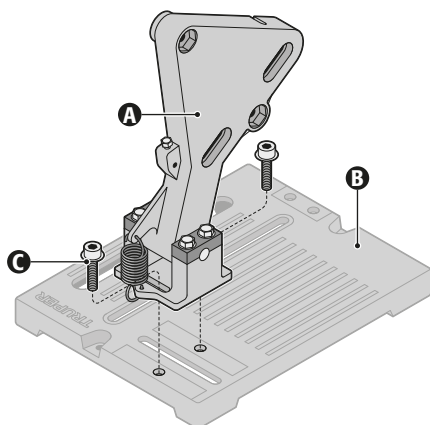

• The base must be fixed to a stable, solid fixed, flat and level workbench before starting by means of two holes (H) and two screws (not included).

⚠ CAUTION To determine the place where the iron base of the support will be mounted, take into consideration the following points:

- Make sure there is a suitable power outlet nearby.
- If the angle grinder stand is to be permanently mounted to a workbench, make sure the workbench is of adequate height, strong, and stable enough to support the weight of the angle grinder, stand, and workpiece.
- Taking into account the length and width of the material to be machined, make sure there is enough space at each end and around the machine to accommodate the largest piece of material to be machined safely.
- Mark the two mounting holes on the workbench surface with a pencil.
- Remove the base and drill the two holes for 5/16" (8 mm) diameter at the marks made.
- Secure the base to the work base with bolts. 5/16" (8 mm) diameter, flat nuts and washers (not included).
- Gradually tighten each bolt one at a time to fully seat the cabinet base.

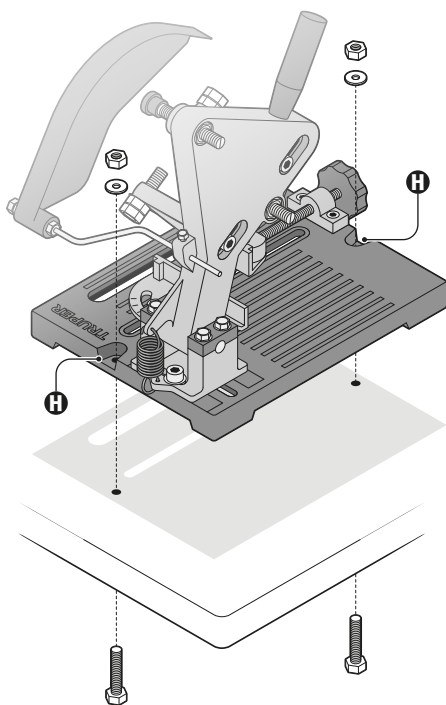

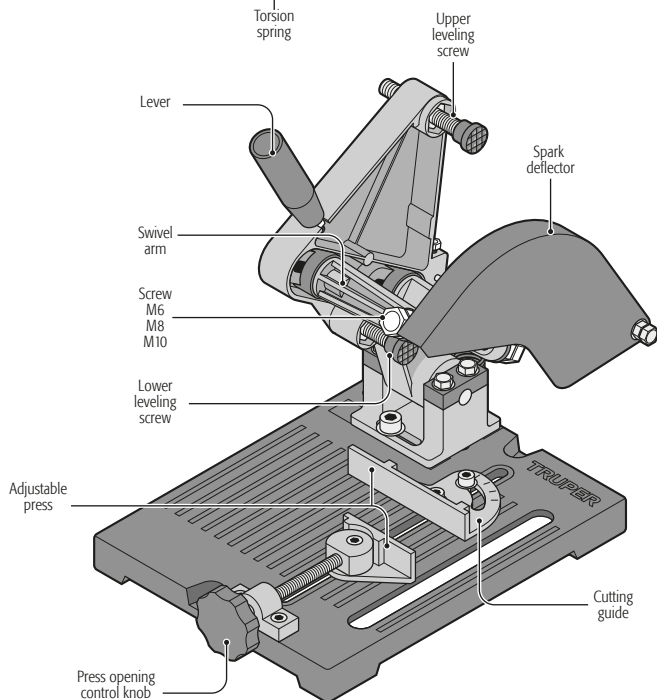
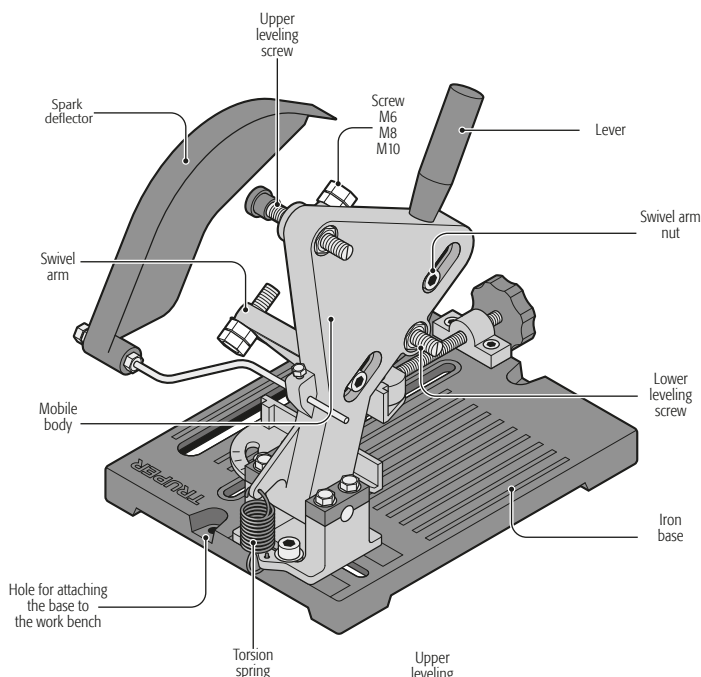

Assembly of the grinding machine

⚠ CAUTION • Make sure that the grinder is switched off during the assembly process.

• Fix the angle grinder (A) between the swivel arms (B) with the two sets of screws and nuts (C) suitable for the diameter of the holes in the grinding head (M6, M8 or M10).

• Once the screws have been assembled, tighten them sufficiently so that the grinder does not move freely.

⚠ CAUTION • Make sure to place the screws with bushing as shown in picture 1; only in this way you will obtain the proper tightening on the grinder (applies for M6 and M8 screws).

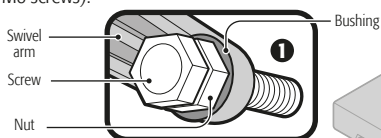

• Using a screwdriver, turn both leveling screws (D) until they make contact with the grinder body.

• Adjust the leveling screws to ensure that the cut-off wheel is at 90° to the base. Use a square (E) to make this adjustment.

⚠ CAUTION • To ensure that the grinder is properly mounted, the two leveling screws must make firm contact in the body of the grinder.

• Once the disc is adjusted to 90°, tighten all the swing arm screws and the leveling screws to prevent the grinder from moving.

• Using the square, check that the disc (F) is aligned to the center of the groove (G) of the iron base. Or lower the lever (H) to verify that the disc passes through the slot and does not contact the iron base.

• If the disc does contact the iron base, loosen the two screws on the movable body (I) and turn it to the left or right until the disc is aligned with the groove.

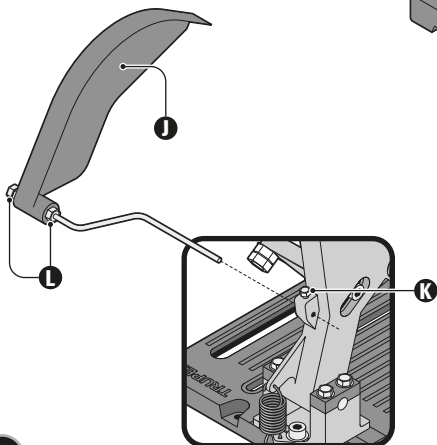
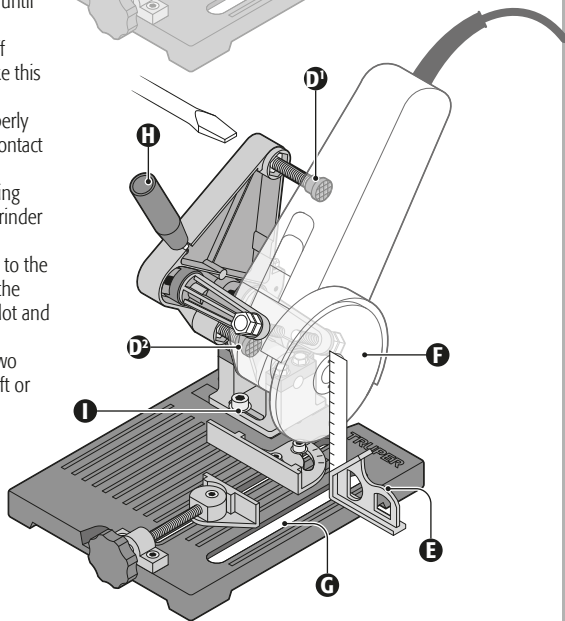
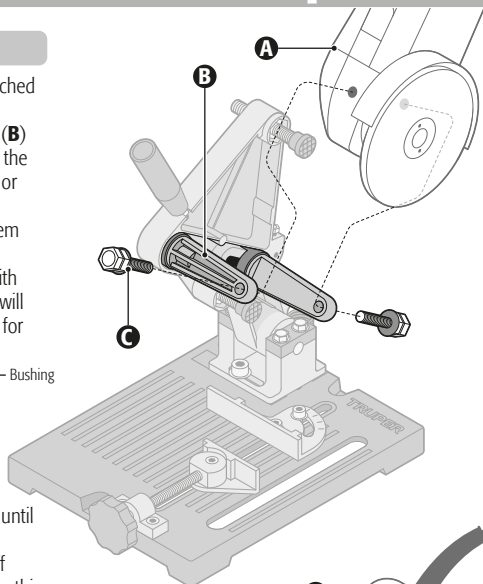

• Place the spark deflector shaft (J) in the rear hole of the moving body and secure it by tightening the screw (K).

• To prevent movement of the spark deflector (J) tighten the two parallel screws (L).

• Connect the grinder, turn it on for a few seconds and turn it off. Check that all screws, nuts and bolts of the assembly are tight.

Adjustable angle press

- The stand should never be used without the workpiece properly clamped.
- To adjust the press:
 1. Turn knob (A) to open the press.
 2. Place the workpiece between the press jaws (B) and then tighten the knob to clamp the workpiece securely.
 3. To change the angle of the workpiece loosen the screws (C), rotate the workpiece to the desired angle and then retighten the screws to set the angle of the workpiece.

Cutting

- Make sure that the disc is not in contact with the workpiece before turning the tool on.
- Switch the angle grinder on and off.
- Wait for the disc to reach its maximum speed.
- Use the lever (D) to lower the moving body with a firm and continuous movement, taking care not to hit or push the workpiece with the disc with too much force, thus avoiding that the disc comes out of its rotation which would cause a bad cut or breakage of the disc.
- Once the blade has entered the workpiece, continue the cut with a smooth and steady motion to achieve a uniform and clean cut.
- At the end of the cut, raise the moving body, turn off the grinder and wait for the wheel to come to a complete stop before checking the workpiece.

⚠ CAUTION • Before making any cuts, take time to determine the ideal way to hold the workpiece.

⚠ CAUTION • Use extra caution when working on very small, very large, or irregularly shaped workpieces.

NOTE It is recommended to use the machine guard as shown in the assembly images.

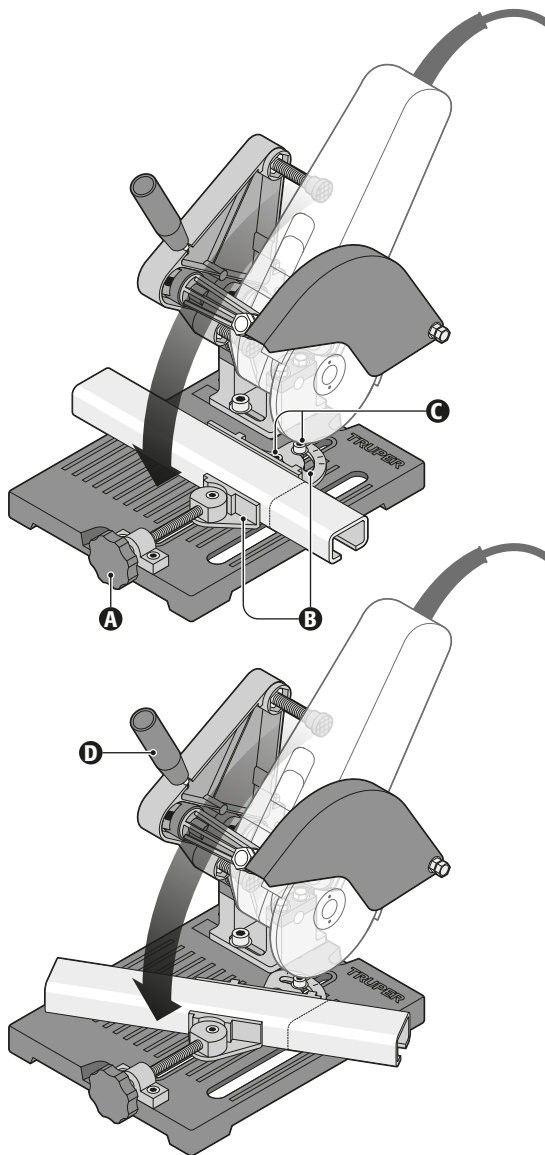

Code	Model	Brand
102273	SOP-E45	 TRUPER®

This product is guaranteed for 1 year against defects in its manufacture, operation and workmanship. To make the warranty valid or purchase parts and components you must present the product in Corregidora 35, Col. Centro, Alc. Cuauhtémoc, CDMX C.P. 06060 or at the establishment where you purchased it. For questions or comments, see www.truper.com or call 800-690-6990. Made in China. Imported by Truper S.A. de C.V. Parque Industrial 1, Parque Industrial Jilotepec, Jilotepec, Edo. de Méx. C.P. 54257



1 YEAR

Date of purchase: